

JVC

SERVICE MANUAL

MICRO COMPONENT SYSTEM

UX-P38V

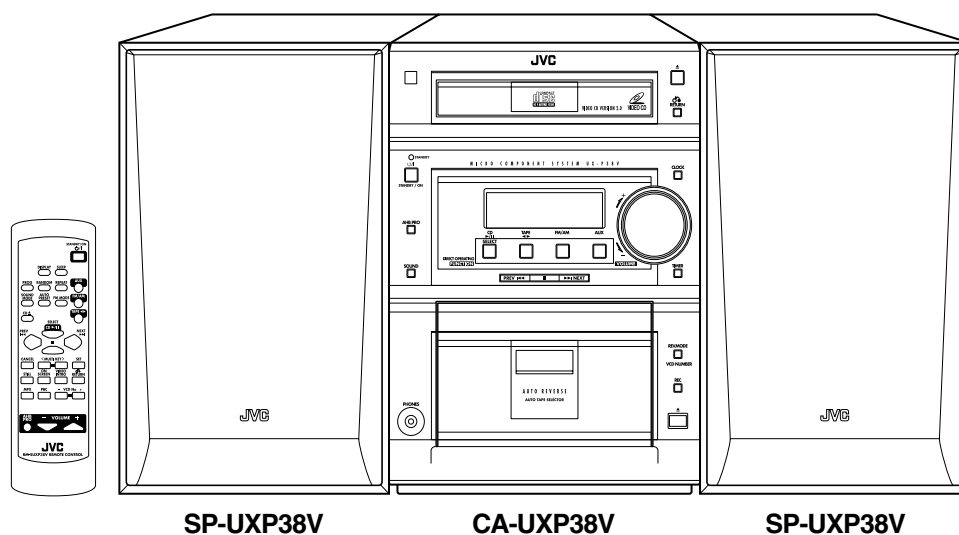

SP-UXP38V

CA-UXP38V

SP-UXP38V



Area Suffix

UF China

This model is UX-P38V UF that is added to the preceding model, the UX-P38V U series.

Please refer to the service manual of UX-P38V (issue No.20965).

■Parts list (General assembly)

P3-4 Block No. M1MM

| △ | Item | Parts name | Parts number | | Q'ty |
|---|------|---------------|----------------|----------------|------|
| | | | US version | UF version | |
| △ | 68 | POWER CORD | QMPK210-205-JN | QMPR320-200-JC | 1 |
| | 81 | REAR PANEL | GV10067-009A | GV10067-013A | 1 |
| | 84 | SPECIAL SCREW | QYSBSF3012E | ----- | --- |
| | 91 | RATING LABEL | GV30172-026A | GV30172-028A | 1 |
| | 95 | CCEE LABEL | ----- | E409372-001 | 1 |
| | 96 | CCIB LABEL | ----- | LV41768-001A | 1 |

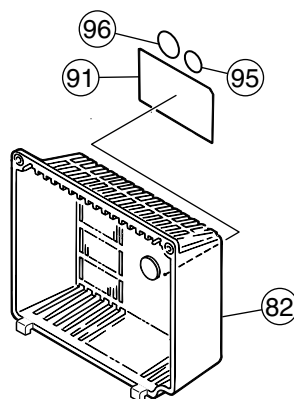

■Electrical parts list (Main board)

P3-9 Block No. 01

| △ | Item | Parts name | Parts number | |
|---|-------|-------------|----------------|--------------|
| | | | USversion | UF version |
| | C2212 | E CAPACITOR | EETC1HM-105ZJC | QETN1HM-105Z |
| | C2213 | E CAPACITOR | EETC1CM-106ZJC | QETN1CM-106Z |
| | C2214 | E CAPACITOR | EETC1HM-105ZJC | QETN1HM-105Z |
| | C2215 | E CAPACITOR | EEKC1CM-226ZJC | QEK1CM-226Z |
| | C2221 | E CAPACITOR | EETC1AM-107ZJC | QETN1AM-107Z |
| | C2222 | E CAPACITOR | EEKC1CM-107ZJC | QEK1CM-107Z |
| | C2224 | E CAPACITOR | EETC1CM-107ZJC | QETN1CM-107Z |
| | C2226 | E CAPACITOR | EETC1HM-105ZJC | QETN1HM-105Z |
| | C2229 | E CAPACITOR | EETC1EM-106ZJC | QETN1EM-106Z |
| | C2235 | E CAPACITOR | EETC1HM-225ZJC | QETN1HM-225Z |
| | C2555 | C CAPACITOR | ----- | QDGB1HK-102Y |
| | C3201 | E CAPACITOR | EETC1CM-107ZJC | QETN1CM-107Z |
| | C3203 | E CAPACITOR | EETC1CM-107ZJC | QETN1CM-107Z |
| | C3205 | E CAPACITOR | EETC1CM-107ZJC | QETN1CM-107Z |
| | C7004 | E CAPACITOR | EEKC1AM-107ZJC | QEK1AM-107Z |
| | C7009 | E CAPACITOR | EETC1HM-225ZJC | QETN1HM-225Z |
| | C7010 | E CAPACITOR | EETC1HM-475ZJC | QETN1HM-475Z |
| | C7011 | E CAPACITOR | EETC1CM-107ZJC | QETN1CM-107Z |

■Electrical parts list (Front board)

P3-12 Block No. 02

| △ | Item | Parts name | Parts number | |
|---|-------|----------------|----------------|----------------|
| | | | US version | UF version |
| △ | F1000 | FUSE | QMF51W2-1R0-J8 | QMF51W2-R50-J8 |
| △ | F1002 | FUSE | QMF51W2-R50-J8 | ----- |
| △ | S1000 | VOLTAGE SWITCH | QSW0812-001 | ----- |
| | Z1004 | FUSE CLIP | QNG0020-001Z | ----- |
| | Z1005 | FUSE CLIP | QNG0020-001Z | ----- |

■Parts list (Packing)

P3-21 Block No. M3MM

| △ | Item | Parts name | Parts number | | Q'ty |
|---|------|----------------|--------------|--------------|------|
| | | | US version | UF version | |
| | P 2 | CARTON ASSY | GV20143-001A | GV20143-002A | 1 |
| | P 3 | CUSHION UPPER | GV10070-001A | GV10070-201A | 1 |
| | P 4 | CUSHION BOTTOM | GV10075-001A | GV10075-201A | 1 |

■Parts list (Accessories)

P3-21 Block No. M5MM

| △ | Item | Parts name | Parts number | | Q'ty |
|---|------|-------------------------|--------------------------------------|-----------------------|------|
| | | | US version | UF version | |
| | A 3 | INST BOOK (LANGUAGE) | GVT0068-003A (ENG,CHI(PEKIN),THA) | GVT0068-011A (CHI) | 1 |
| | A 4 | MP3 SHEET | GV20162-001A | GV30300-001A | 1 |
| △ | A 6 | AC PLUG ADAPTER | QAM0112-001 | ----- | --- |
| | A 12 | S.CENTER LIST | ----- | BT-59009-1 | 1 |
| | A 13 | WARRANTY CARD | ----- | BT-59007-2 | 1 |



VICTOR COMPANY OF JAPAN, LIMITED
AUDIO & COMMUNICATION BUSINESS DIVISION
PERSONAL & MOBILE NETWORK BUSINESS UNIT. 10-1,1chome,Ohwatari-machi,Maebashi-city,371-8543,Japan